

Sliding Door Bottom Rolling

Designed to meet the everyday rigors of the New Zealand built environment, the BR200 range of sliding hardware will perform effortlessly year in and year out.



Design Features

The BR200 has been designed to meet the requirements of NZS 4211.

The range has been designed specifically for the harsh NZ conditions so you can be assured effortless opening year on year.

Materials

Our standard bottom roller is made almost entirely from stainless steel. Chosen for its excellent strength properties, while being extremely corrosion resistant.

Testing

NZS4211 Compliant

Thorough design and manufacturing controls, mean nothing without proof it will perform in the real world.

This range has been subjected to extensive cycle and load testing.

Specifications

Specifications	Detail
Max Panel Weight	200kg
Max Panel Height	4m
Roller Width	25mm
Height Adjustable	+/- 5mm

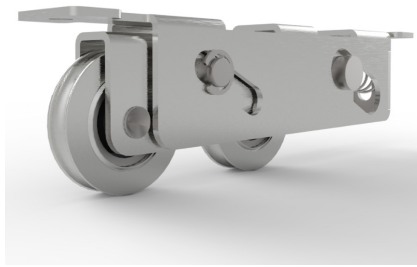

Components

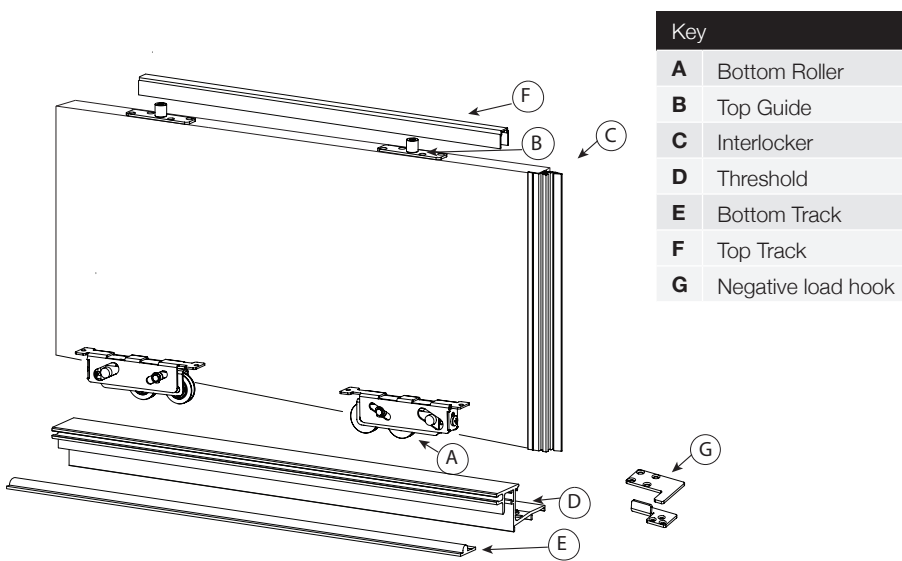

NZS 4211 Compliant System

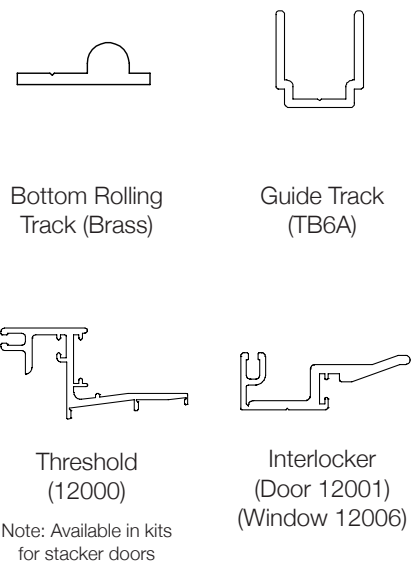

Accessories

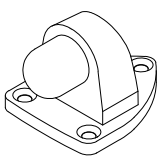

Door Stop
316 S/S
(SDS26)

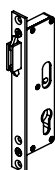

Sliding Lock
(LCS40)

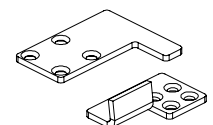

Negative Load Hooks S/S
(12060LH or RH)

End View

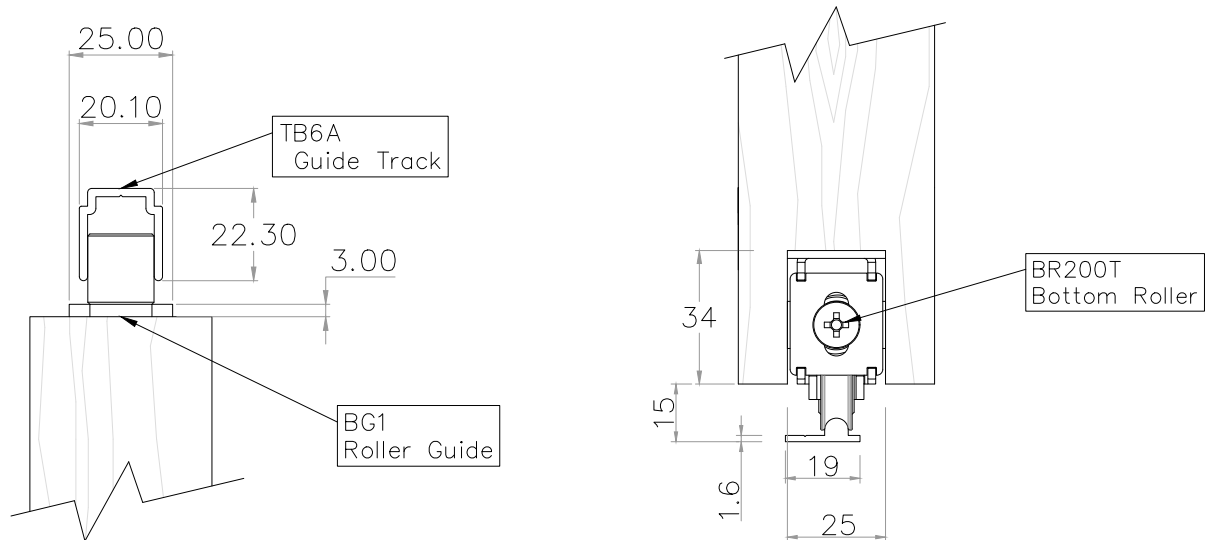

Top View

